



# Santa Fe CLASSIC

The **Santa Fe Classic** has a vertical configuration and its' flow-down design performs exceptionally well in basements. The high capacity blower on the unit moves air in a way that no small conventional unit can. The Classic's optional condensate pump and ducting kits provide the flexibility necessary for any application.

<b>Part Number:</b>	4029700	
<b>Blower:</b>	275 CFM @ 0.0" WG	
<b>Power:</b>	700 watts @ 80°F and 60% RH	
<b>Supply Voltage:</b>	115 volt – 1phase – 60 Hz	
<b>Current Draw:</b>	6.4 amps	
<b>Operating Temp.:</b>	56°F Min., 95°F Max.	
<b>Sized For:</b>	(Refer to website for more sizing considerations)	
<b>Basement</b>		
Very Tightly Sealed	Up to 3,000 Sq. Ft. (30,000 Cu. Ft.)	
Moderately Sealed	Up to 2,700 Sq. Ft. (27,000 Cu. Ft.)	
Some Leaks & Imperfections	Up to 2,500 Sq. Ft. (25,000 Cu. Ft.)	
<b>Minimum Performance at:</b>		
	<b>80°F and 60%RH</b>	<b>70°F and 60%RH</b>
<b>Water Removal:</b>	110 Pints/Day	90 Pints/Day
<b>Efficiency:</b>	6.3 Pints/kWh	5.8 Pints/kWh
<b>Energy Factor:</b>	3.0 L/kWh	2.7 L/kWh
<b>Air Filter:</b>	MERV-13, Standard Pleat	
<b>Size:</b>	16" x 20" x 2"	
<b>Power Cord:</b>	9', 115 VAC, Ground	
<b>Drain Hose:</b>	6' Direct Gravity Drain Hose (9/16" ID x 3/4" OD)	
<b>Refrigerant Type:</b>	R410A (Refer to manufacturers label for more information)	
<b>Refrigerant Amount:</b>	1 lb., 9 oz.	
<b>Dimensions:</b>	<b>Unit</b>	<b>Shipping</b>
Width:	20"	24"
Height:	36"	44"
Length:	17"	21"
Weight:	110 lbs	117 lbs

<b>Optional Accessories:</b>		
4021468	Pre-Filter	
4028522	Pre-Filters 12-Pack	
4037723	MERV-13 Filter (16" x 20" x 2")	
4037733	MERV-13 Filters 4-Pack	
4037734	MERV-13 Filters 12-Pack	
4024528	Bulk Carbon Granules	
4022220	Pump Kit	
4022561	Muffler Kit	
4021453	Duct Kit (includes 8" supply collar)	
4020656	6" Inlet/Exhaust Hood	
4026859	6" Flex Duct 25'	
4020128	6" Flex Insulated Duct 25'	
4029623	8" Supply Collar	
4027415	8" Flex Duct 25'	
4020177	8" Flex Insulated Duct 25'	
4020175	Remote Dehumidistat	

- Vertical configuration great for basement applications
- High capacity blower for **optimal air movement**
- Optional duct kits and condensate pumps provide **multiple installation options** for greater flexibility
- Exceeds ENERGY STAR®** efficiency requirements
- Large capacity** water removal of 110 pints/day
- MERV-13 filter provides **superior air filtration**
- Engineered for **low temperature operation** and the air flow issues that basements present
- Auto restart** allows the dehumidifier to automatically restart after a power outage

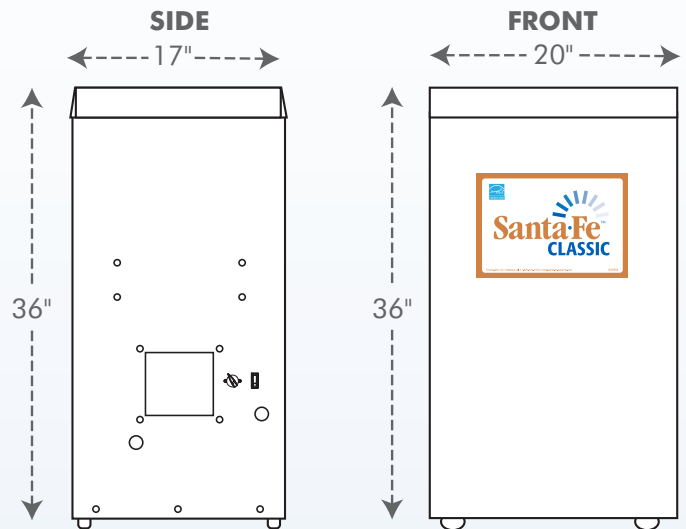

[www.Santa-Fe-Products.com](http://www.Santa-Fe-Products.com)  
**1.800.533.7533**

# Recommended Installations for Ducting to Finished Areas

## Installation of a Santa Fe Classic With a Supply Kit Only

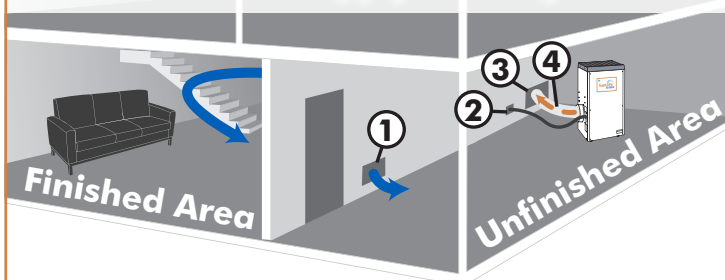

- ① Passive Return Vent
- ② Optional Wall Mount Dehumidistat (mounts on opposite wall in finished area)
- ③ Supply Grill
- ④ Supply/Discharge Duct Work

- Place the Santa Fe Classic in the unfinished area of the basement, near a drain access (condensate will drain via gravity or with an optional pump kit).
- Using the supply duct collar, supply the dry air from the dehumidifier into a large, open area in the finished section of the basement.
- Place a return grill / passive vent on the other side of the wall that separates the finished and unfinished areas. This will allow for a circular air flow throughout the basement.
- The passive grill will prevent the unfinished room from being placed under a negative pressure and also allow the dehumidifier to focus on keeping the unfinished area dry as well.
- The onboard dehumidistat control can be used on the unit for this application or a 120 volt dehumidistat can be placed in the finished basement as well (we recommend using an electrician to run the wiring).
- Be sure to keep all doors open to any other rooms in the basement to help with proper air circulation (bedrooms, bathrooms, etc.)

## Installation of a Santa Fe Classic With a Supply and Return Duct Kit

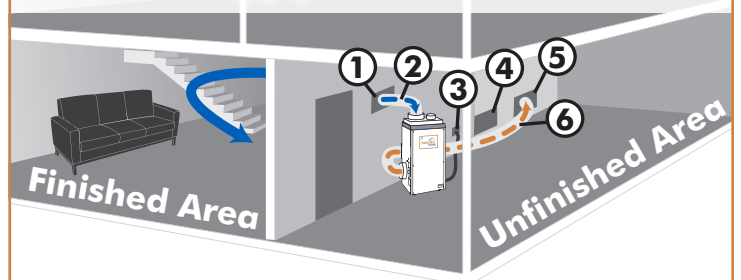

- ① Return Grill
- ② Return/Intake Duct Work
- ③ Optional Wall Mount Dehumidistat (mounts on opposite wall in finished area)
- ④ Passive Return Vent
- ⑤ Supply Grill
- ⑥ Supply/Discharge Duct Work

- Place the Santa Fe Classic in the unfinished area of the basement, near a drain access (condensate will drain via gravity or with an optional pump kit).
- Using the supply and return duct kit, supply the dry air from the dehumidifier into a large, open area of the finished basement. Use the return duct kit to draw air back through the dehumidifier.
- Be sure the return and supply are at least 10 feet away from each other for proper air flow throughout the basement. Add a passive grill between the finished and unfinished areas (\*or have a 2" gap under the door separating the two rooms). This will help keep the unfinished area dry as well.
- Use the 120 volt, wall mounted dehumidistat for this installation for proper run time on the dehumidifier (we recommend using an electrician to install the separate 120 volt control).
- Be sure to keep all doors open to any other rooms in the basement to help with proper air circulation (bedrooms, bathrooms, etc.)



**The Best in the Industry!**



Email - [Info@OceanStateAir.com](mailto:Info@OceanStateAir.com)  
Web Site: [www.OceanStateAir.com](http://www.OceanStateAir.com)

[www.Santa-Fe-Products.com](http://www.Santa-Fe-Products.com)

Rev 10/16/17